



# **Performance Oil Catch Can Kit**

## **Part Number: 860-005**

**2010-2023 Lexus GX460 4.6L**

## **Installation Instructions**

For technical inquiries please email us at [tech@hpsperformance.com](mailto:tech@hpsperformance.com)

In the email, please include the following information for faster response:

- Year / Make / Model / Engine of your vehicle
- If it is a fitment issue, please include pictures showing the fitment problem
- If there are missing parts, please list the part number(s) from the bill of materials on the 2nd page
- Optional but recommended – Your contact phone number and preferred call back time

You can also give us a call via 626-747-9200 for tech support Monday-Friday, 9:00am-5:00pm Pacific Time.

# Bill of Materials

## Kit Number: 860-005

Line #	Description	Part Number	Qty
1	Oil Catch Can	OCC-14	1
2	Oil Catch Can Bracket	OCC-BRKT-005	1
3	Oil Catch Can Support Bracket	OCC-BRKT-011	1
4	Bolt, M5 x 0.8, 10mm Long	HW-B5-10	3
5	Straight Aluminum Adapter, AN-8 to 16mm x 1.50	AN816-8-M1615	2
6	Push-On Aluminum Hose End, AN-8, 90 Degree	150-9008	2
7	Bolt, M6 x 1.0, 12mm Long	HW-B6-12	1
8	Bolt, M6 x 1.0, 16mm Long	HW-B6-16	2
9	Flat Washer, M6, 16mm OD	HW-FW6L	5
10	Flange Nut, M6	HW-N6	2
11	150 Series Push-On Hose, AN-8	150-08	9 inches
12	150 Series Push-On Hose, AN-8	150-08	11.25 inches
13	Embossed Hose Clamp, 12mm - 22mm	EMSC-12-22	2
14	Barb Fitting, 1/2"	HW-BF-050	1

- **Before installing any parts of this oil catch can kit, please read the instructions thoroughly.**
- **Verify the contents of this oil catch can kit before disassembling your vehicle.**
- **Report any defective or missing parts to HPS directly. The HPS dealer you purchased this product from might not have the replacement parts you need.**
- **Installation requires moderate mechanical skills. A qualified mechanic is highly recommended.**
- **Do not attempt to install the oil catch can kit while the engine is hot.**
- **This installation may require the removal of coolant lines that may be hot.**
- **For technical inquiries, please email us at [tech@hpsperformance.com](mailto:tech@hpsperformance.com)**

## **PLEASE READ CAREFULLY BEFORE INSTALLATION!**

This installation is not for the novice customer. Install this product with EXTREME caution! Misuse of this product can destroy your engine! If you are not mechanically inclined, please have a professional automotive mechanic install this kit.

**NOTE: HPS holds no responsibility for any engine damage that results from misuse of this product.**

## **GETTING STARTED**

1. Turn the ignition OFF and disconnect the vehicle's negative battery cable. If the engine has run within the past two hours, let it cool down.

NOTE: Disconnecting the negative battery cable erases pre-programmed electronic memories. Write down all memory settings before disconnecting the negative battery cable. Some radios will require an anti-theft code to be entered after the battery is reconnected. The anti-theft code is typically supplied with your owner's manual. In the event your vehicle's anti-theft code cannot be recovered, contact an authorized dealership to obtain your vehicle's anti-theft code. We also highly recommend NOT discarding any stock parts after the installation.

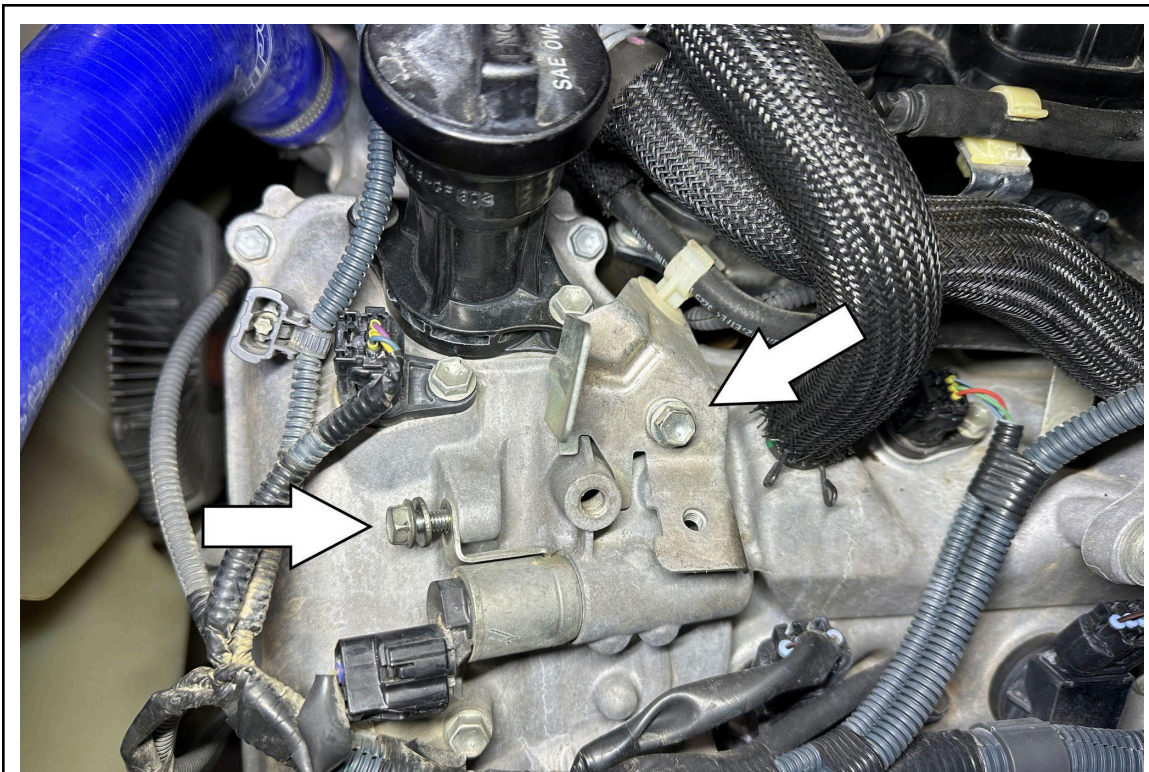

2. Remove the engine cover to access the driver side valve cover. Remove both the bolt holding the bracket and the bolt holding the VVT solenoid from the vehicle.

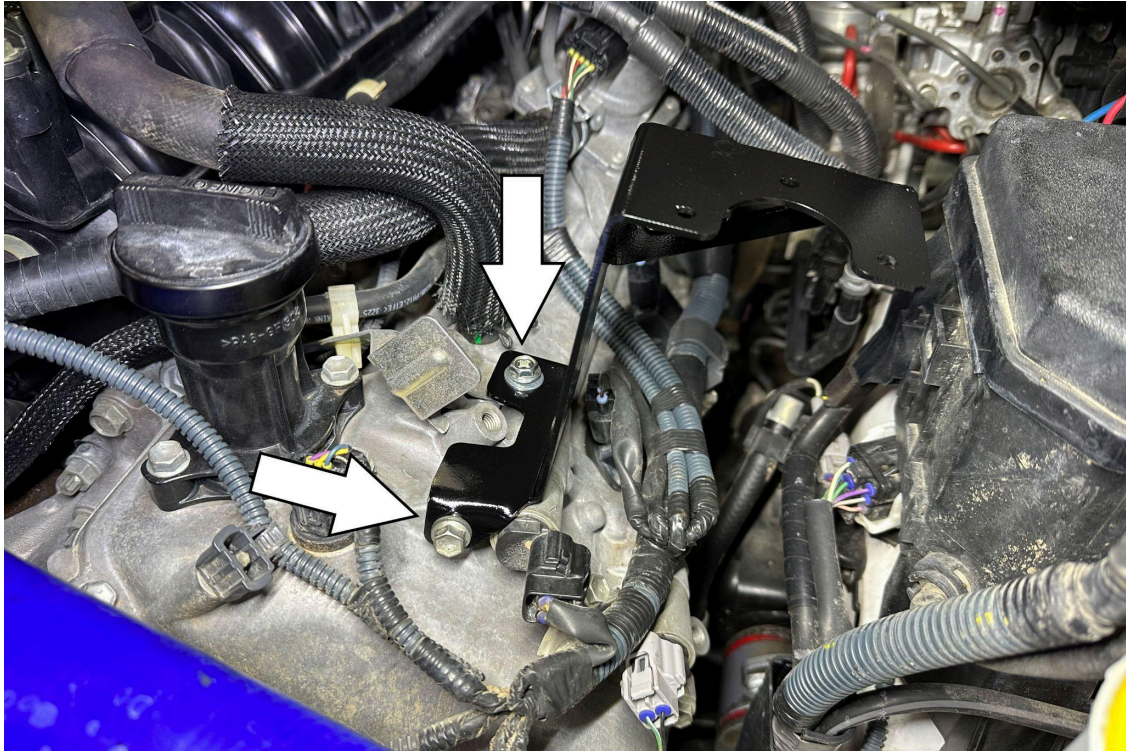

3. Secure the oil catch can bracket using the original bolt for the front mount and the provided M6 x 12mm long bolt and washer for the rear mount on the stock bracket.

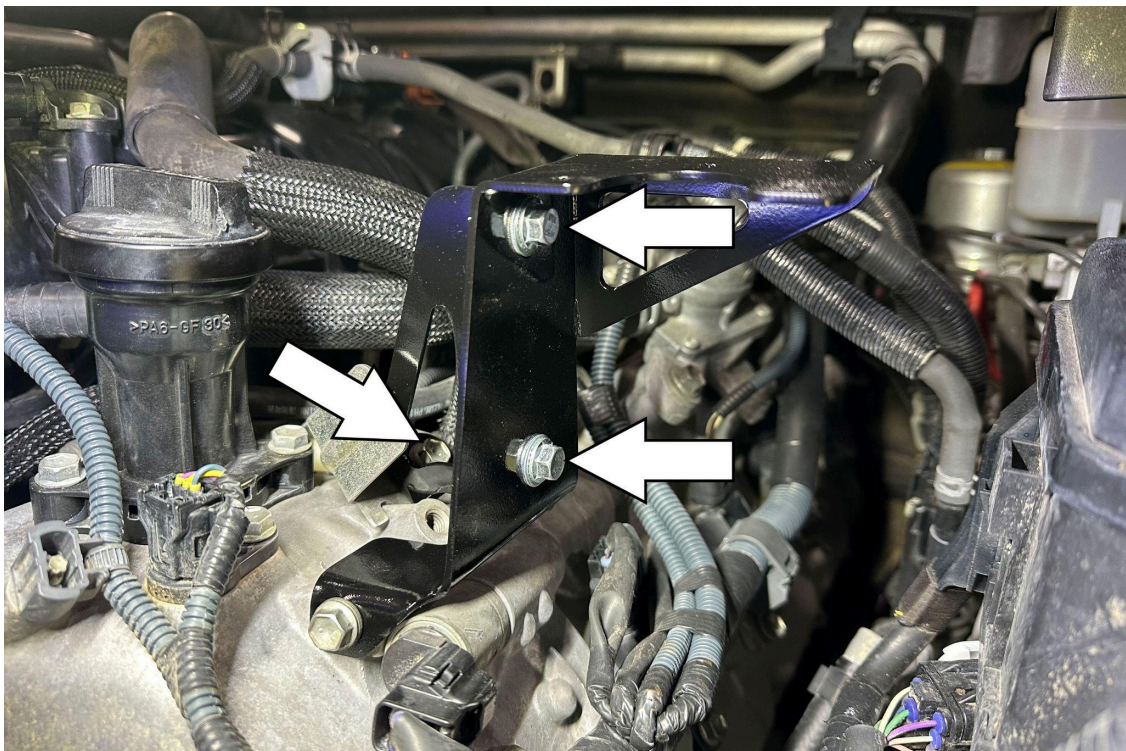

4. Bolt the oil catch can support bracket onto the main bracket using two provided M6 x 16mm long bolts, two nuts, and four washers. Use the original bolt to secure the support bracket to the valve cover. Tighten down all fasteners once all bolts are threaded in.

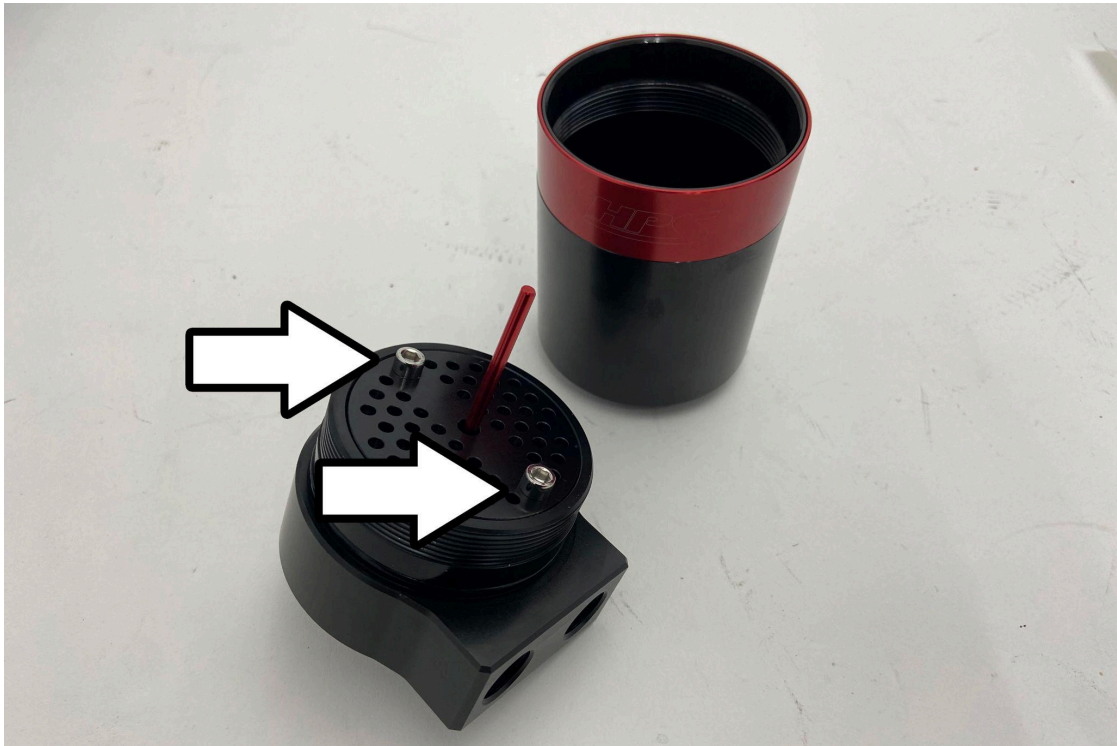

5. Unscrew the top of the HPS Oil Catch Can and check that the Allen bolts are tight.

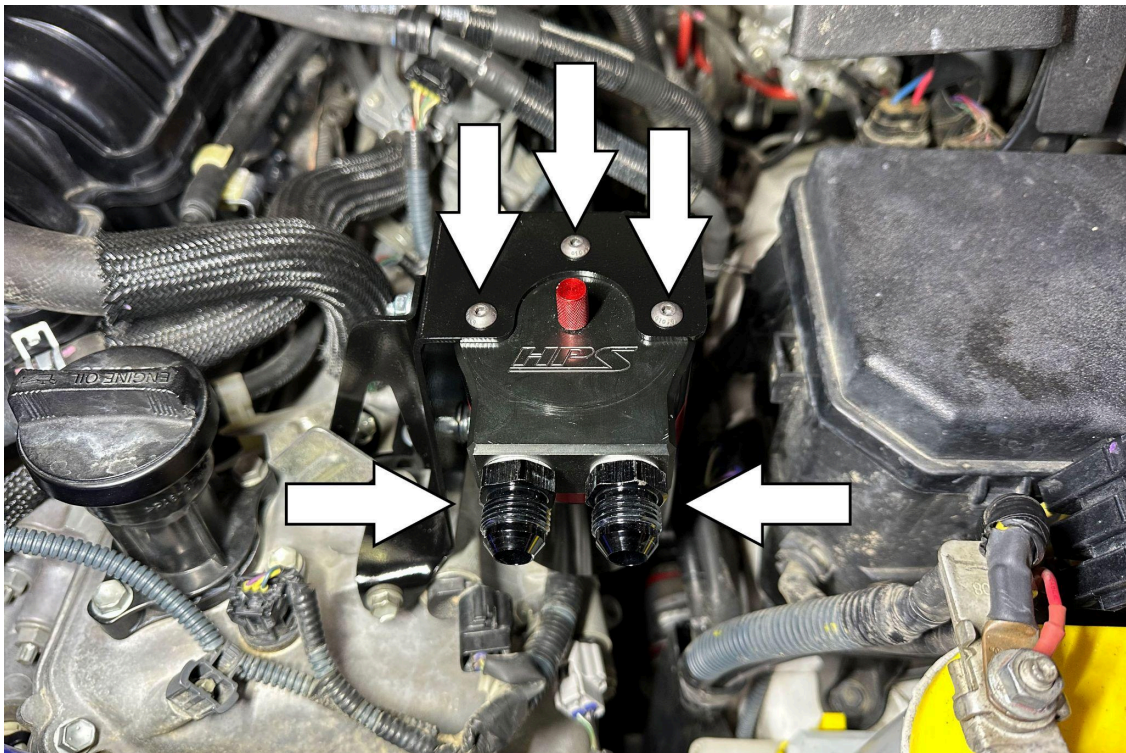

6. Slide the provided crush washers onto the metric side of the provided AN to M16 adapter fittings, then fasten the adapters onto the oil catch can. Mount the oil catch can using the three provided M5 bolts.

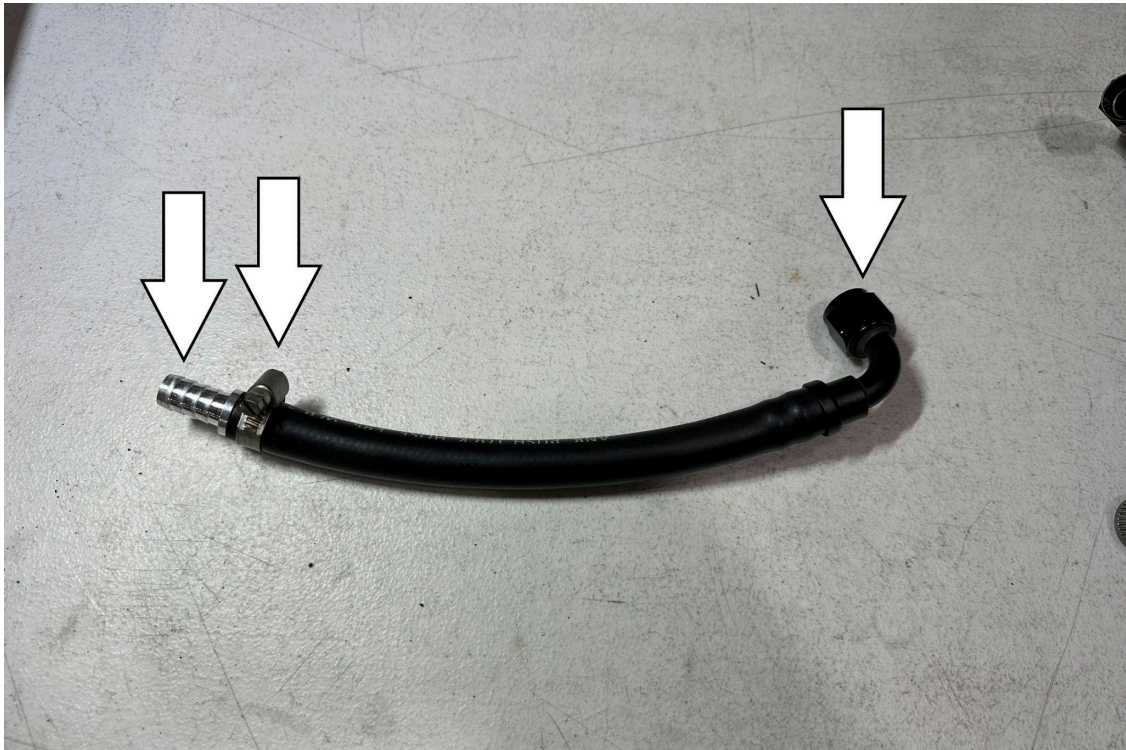

7. Press the 8 inch long hose onto the 90 degree hose end fitting. On the opposite side of the hose, press on the 1/2" barb fitting and secure it with a provided embossed hose clamp.

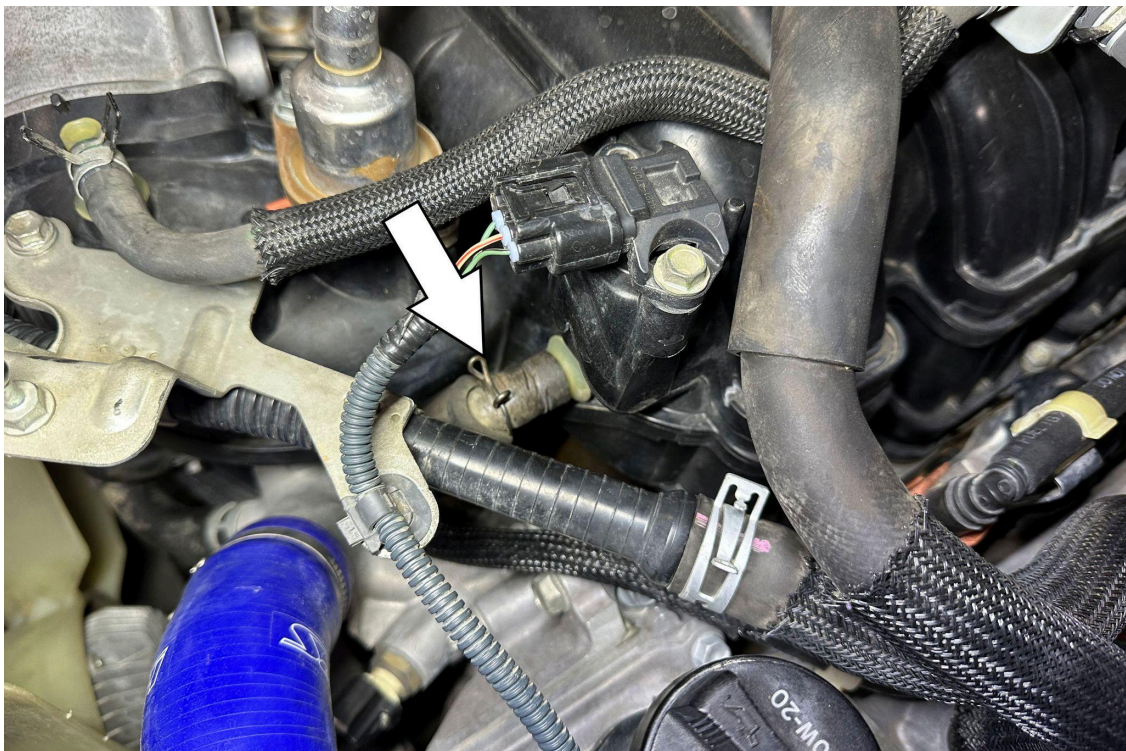

8. Disconnect the PCV hose from the intake manifold.

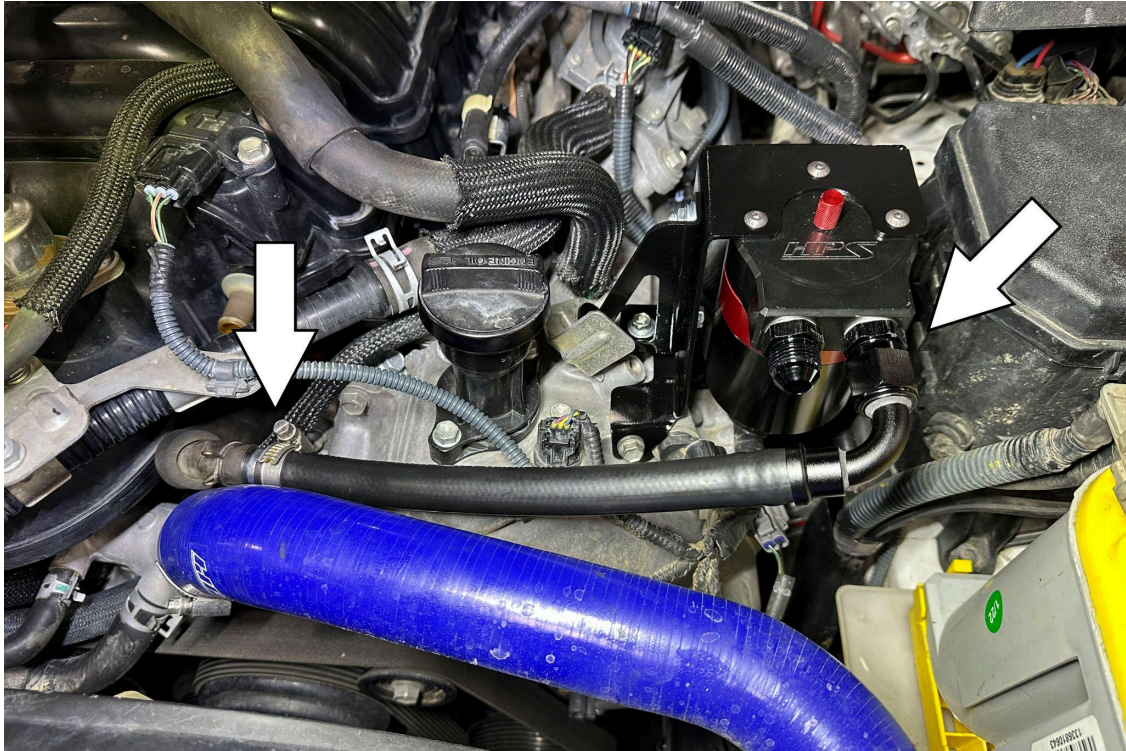

9. Connect and secure the 1/2" barb fitting to the PCV hose and fasten the 90 degree hose end fitting onto the oil catch can.



10. Press the 11-1/4 inch long hose onto the 90 degree hose end fitting.

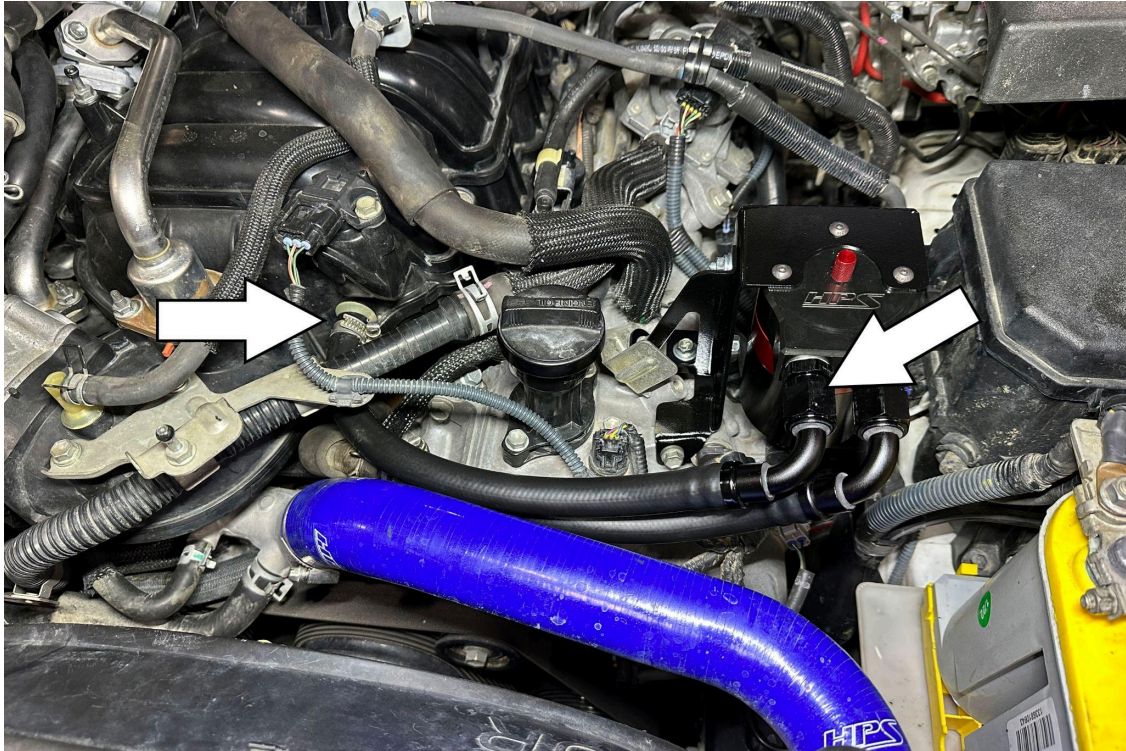

11. Fasten the 90 degree hose end fitting onto the oil catch can. Press the opposite end of the hose onto the port on the intake manifold and secure the hose with the provided embossed hose clamp.



## **FINAL STEPS**

Upon completion of the installation, reconnect the negative battery terminal before you start the engine. Double check to make sure everything is tight and properly positioned before starting the vehicle.

Start the engine. Let the car idle for 3 minutes. Perform a final inspection before driving. Listen carefully for any odd noises or rattles prior to taking it for a test drive. If any problems arise, go back and check the hoses and clamps that may be causing the issue and correct the problem.

Ensure that the dipstick on the HPS oil catch can is fully seated. Failure to install the dipstick properly will result in a check engine light and poor performance.



**Also available for:  
Lexus 2010-2023 GX460 4.6L V8**



**HPS Performance Silicone Radiator Hose Kit**  
Part Number [57-2127](#)



**HPS Performance Stainless Steel Magnetic  
Oil Drain Plug**  
Part Number [MDP-M12x125](#)

Contact an authorized HPS Performance dealer or  
visit us at [hpsperformance.com](https://www.hpsperformance.com) for more details